

Maxi/Mini Heat Press

How to adjust a Micro Switch

Adjustment of Micro Switch

- N.B.** Before undertaking any work, switch off the power supply to the machine and unplug the machine from the electricity supply
1. Put the Heat Plate in the down position
 2. Support Micro Switch Lever underneath, where button comes out from Micro Switch, with a finger (pic 1)
 3. Bend Lever on Micro Switch downward, towards Heat Plate
 4. Lift Heat Plate back into the up position and check that the Micro Switch Lever makes contact with the Heat Plate Cover and resets the Timer on the Display
 5. If the Timer on the Display does not reset repeat steps 2 to 4 until desired operation is achieved

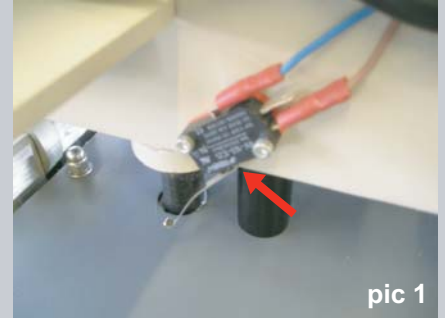

pic 1